

Specification Sheet

SB815HF

Standard Low-Pressure Type of Polyamide Reverse Osmosis Membrane Element

■ Application

- Brackish water, groundwater, surface water, tap water treatment etc.
- Liquid concentration, sewage wastewater and reclaimed water recycle etc.
- Production water supply system for electronics, power, steel & iron, pharmacy, thermoelectric, petrochemical, coal to chemicals etc.
- Feed TDS below 5,000 mg/L

■ Specification

Membrane Surface Area(Nominal)	40.9 m² (440 ft²)	
Feed spacer thickness	28 mil	
Permeate flow	49.2 m³/d (13,000 GPD)	*1, *2
Nominal Salt Rejection	99.5%	*1
Minimum Salt Rejection	99.4%	*1

(*1) Test condition : Feed Pressure 1.55 MPa (225 psi), Temperature 25 deg. C, Feed water concentration 2,000 mg/L as NaCl, Recovery ratio 15%, Feed water pH 7.5 - 8.0

(*2) Individual permeate flow rate may vary +/- 15%

■ Operating limits

Maximum Pressure	4.14 MPa (600 psi)
Maximum Temperature	45 °C
Maximum Feed water SDI₁₅	5
Maximum Feed water flow	17 m³/hr
pH range during operation	3 - 10
Free chlorine of feed water	Not detectable
Maximum element pressure drop	0.1 MPa (15 psi)

■ Element Dimension

A	Outer diameter	200 mm (7.9 inch)
B	Length	1,016 mm (40 inch)
C	Diameter of permeate tube	28.6 mm (1.125 inch)

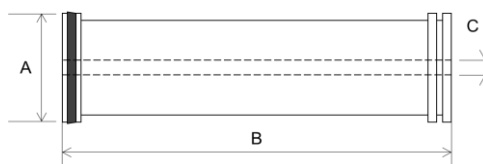

All the information is understood to be subject to change without prior announcement. For more detail, refer to the manual and/or contact us.

TOYOBO MC Corp.

Water Treatment Membrane Sales Unit

Phone: +81-6-6348-3360

E-mail: Membrane@toyobo-mc.jp